

Front-Load Heavy Duty Stapler



- ◆ Robust, extra heavy duty stapler with steel components.
- ◆ Comfortable operation and high volumn.



05001 / 05003 (Heavy Duty Stapler)

Item No.	Description	Capacity	Insert depth	Staples	Staples Capacity	
05001	Heavy Duty Stapler	140 sheets	9~59 mm	23/6 ~ 23/17	100 pcs	
05003		200 sheets	12~56 mm	23/6 ~ 23/23		

- ⊙ Major Material : Plastic body and quality steel componets
- ⊙ Front loading makes refilling easy

Remove the jammed staples

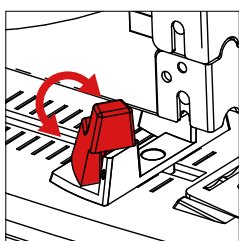

Rotate the red button inward 90° and press down the handle to eject the jammed staples.

Paper Guide

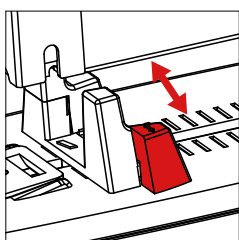

Pull out the red button to adjust the paper guide to a proper position and push in to lock the paper guide.

Select anvil clincher (only for 05003)

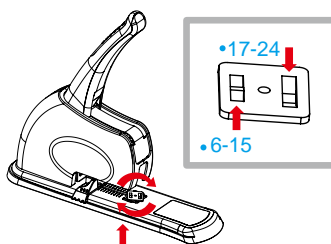

Rotate Anvil to fit different size of staples

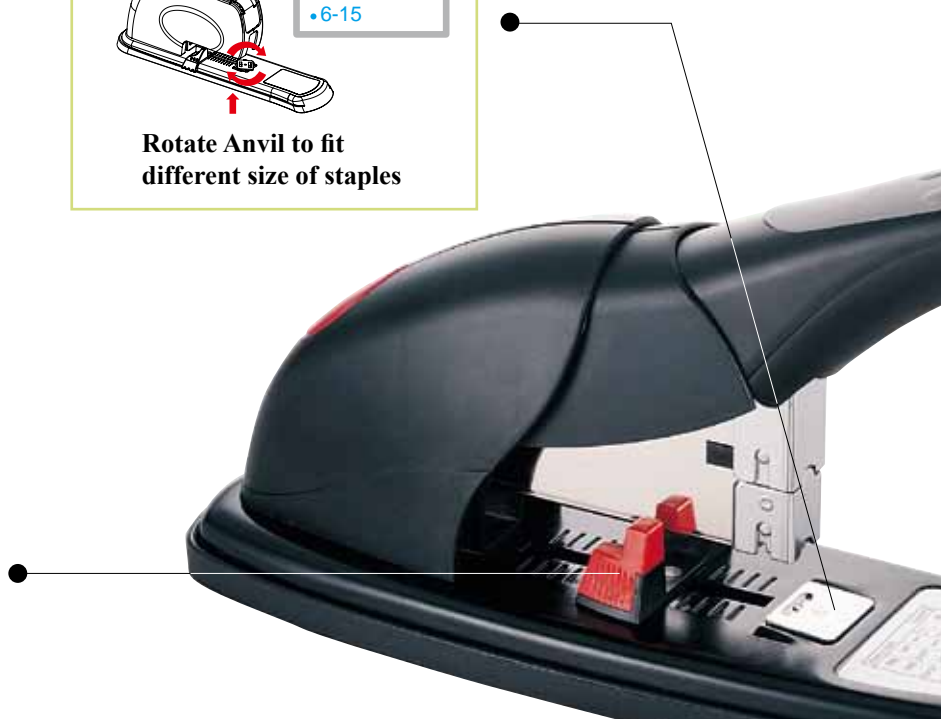

01
02
03
04
05
06
07
08
09
10
11
12
13
14
15
16
17
18
19
20
21



Front-Load Heavy Duty Stapler

Robust, extra heavy duty stapler with steel components. Effortless operation.

➤ **05001 Heavy Duty stapler**

- * Capacity up to 140 sheets of 80 gsm paper.
- * Soft hand grip provides you an effortless operation.
- * 8-75mm adjustable stapling margin.
- * Front loading makes refilling easy.
- * A patent design for removing the jammed staples.
- * Use staples 23/6 - 23/17

Color



05001



Remove the jammed staples

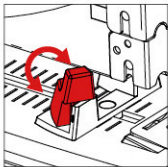

Rotate the red button inward 90° and press down the handle to eject the jammed staples.

Paper Guide

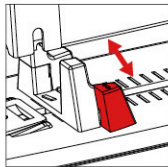

Pull out the red button to adjust the paper guide to a proper position and push in to lock the paper guide.

Color



- Capacity up to 140 sheets
- Soft hand grip provides you a comfortable operation
- 9-59mm adjustable stapling margin
- Front loading makes refilling easy
- A patent design for removing the jammed staples
- Use staples 23/6 - 23/17
- Size : 320 x 88 x 177mm

Item No.	Capacity	Insert depth	Staples	Staples Capacity	
05001	140 sheets	9~59 mm	23/6~23/17	100 pcs	